

LOWER LEVEL

Take photos of your favorite items and activities then tag them with #WoodworkersShowcase. The NWA is @NWAWoodworking on Instagram.

RR = REST ROOMS

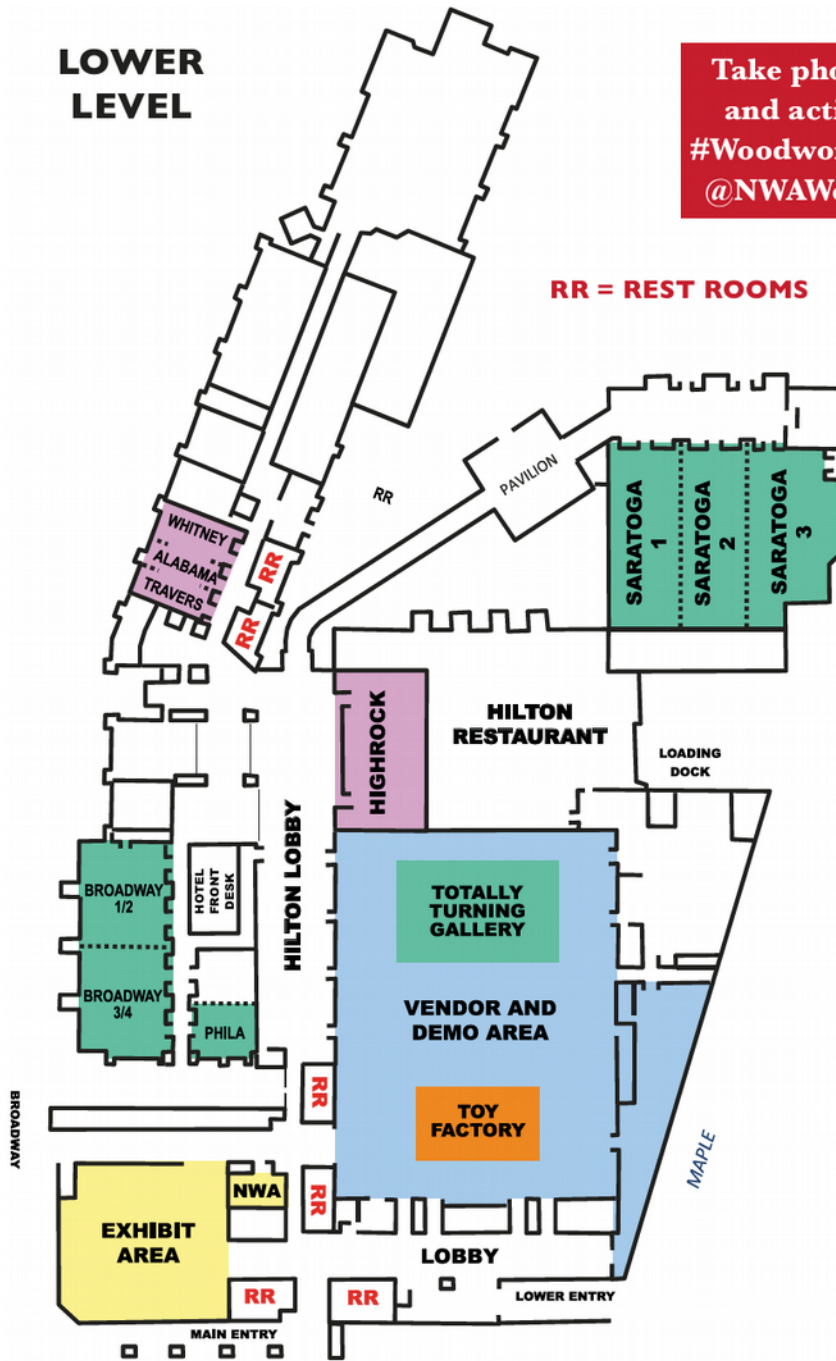

EXHIBIT HALL AREA

- Showcase Exhibit - Many forms of fine woodworking
- NWA Showcase Office - Questions? Visit Us Here

VENDOR AND DEMO AREA

- Many Varied Vendor Sales
- Great Raffle Items
- NWA Store & Gift Shop
- NWA Membership Booth
- NWA Handtool Education
- Woodworking Demo's:
- Totally Turning - Instant Gallery

TOY FACTORY AREA

- The Children's Toy Factory (Hands – on participation for Kids)

TOTALLY TURNING AREA Woodturning Symposium

- Totally Turning Rotations (Separate Registration Fee)
- Totally Turning Gallery

CLASSES AREA

- Free Classes Featuring Professional and local talent

Totally Turning Symposium has a free exhibit gallery dedicated to their woodcraft:

ALTERNATE MATERIALS: Alternate materials that are cast or added to wood to create unique, original pieces including plastics, resin, metal, stone, etc.

ARTISTIC: Exquisitely Finished Turned art - carved, pierced, sculpted, or otherwise enhanced

BOWLS: Any turning which resembles or may be used as a bowl

HOLLOW FORMS: Narrow, closed, or open mouth hollowed turnings either with hand tools or jog assisted, includes vases, urns, weed pots, etc.

JEWELRY: Turned items for wrist, neck, finger, or other body wear

NOVICE: Those who began turning within the last twelve months. Covers all categories for any turned piece from a new turner.

PENS: Turned fine writing implements

PLATTER: Any turning which resembles a plate or platter

SEGMENTED: Turnings comprised of multiple systematic layered individual pieces

SPINDLE: Any piece turned primarily between centers with marginal hollowing; ornaments, pepper mills, rolling pins, finials, canes, goblets, boxes, eccentric, offset, etc.

YOUTH:** For turners 17 years old or younger. Covers all categories for any turned piece from a young turner.

Learn more about the **Northeastern Woodworkers Association** by visiting our website at www.woodworker.org and @NWAWoodworking on Instagram